

QUIKRULER™ II QUICK START GUIDE

Measurement software for use with GTCO CalComp by Turning Technologies Roll-Up™ Digitizers and Palm™ Handheld Organizers

Contents

- Installing the software
- Connecting the hardware
- Measurement functions
- Preferences
- Units
- Scale
- Making measurements
- Calculations
- Combining measurements
- Categories
- Using QuikRuler II

Installing the Software

1. Insert QuikRuler II CD-ROM into your PC.
2. Follow installation and registration instructions.
3. Attach Palm to PC and perform HotSync.
4. QuikRuler II should now be loaded.

Connecting the Hardware

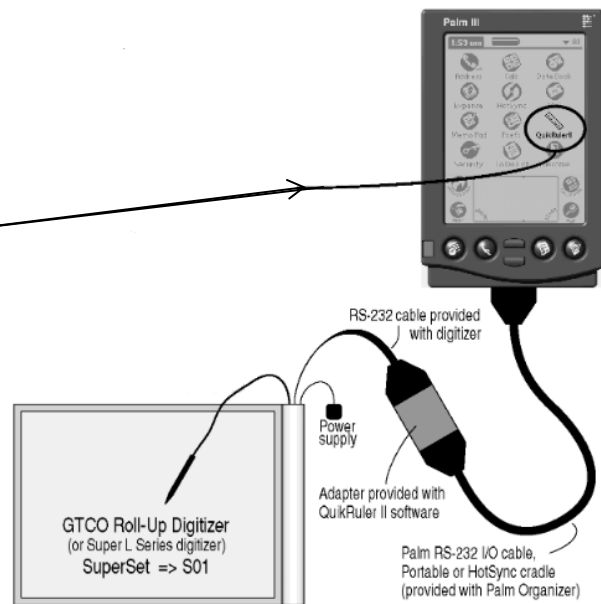

NOTE: QuikRuler II works only with Palm Handheld Organizers. Hardware incompatibility prevents use with other brands.

Preferences

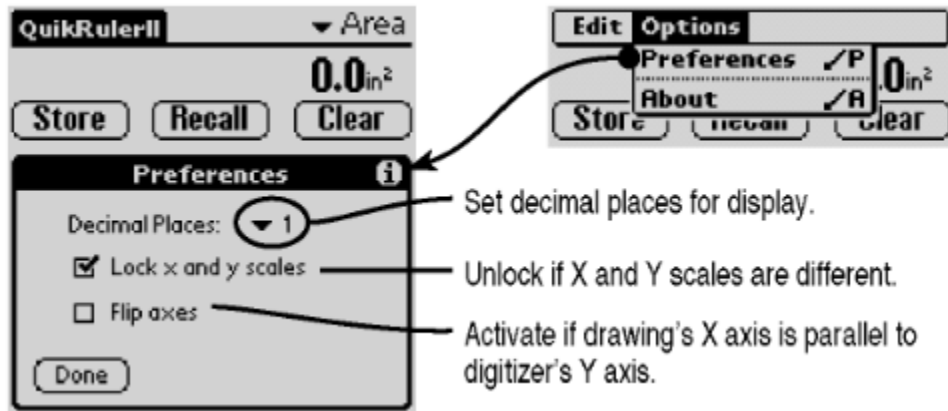

Measurement Functions

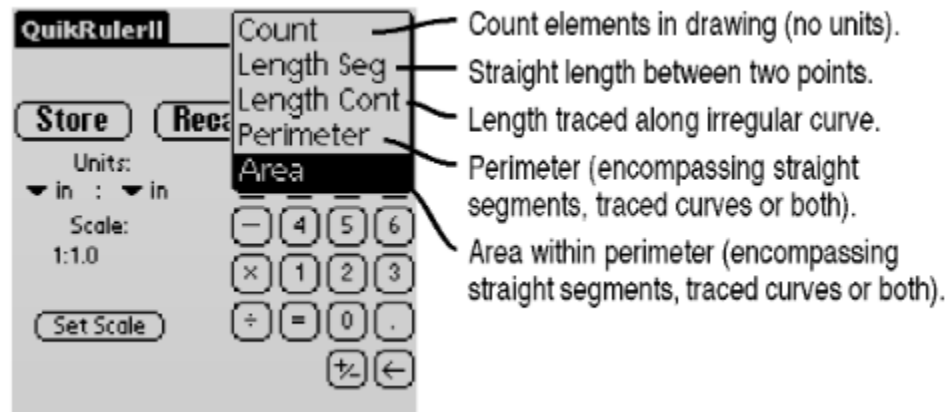

Units

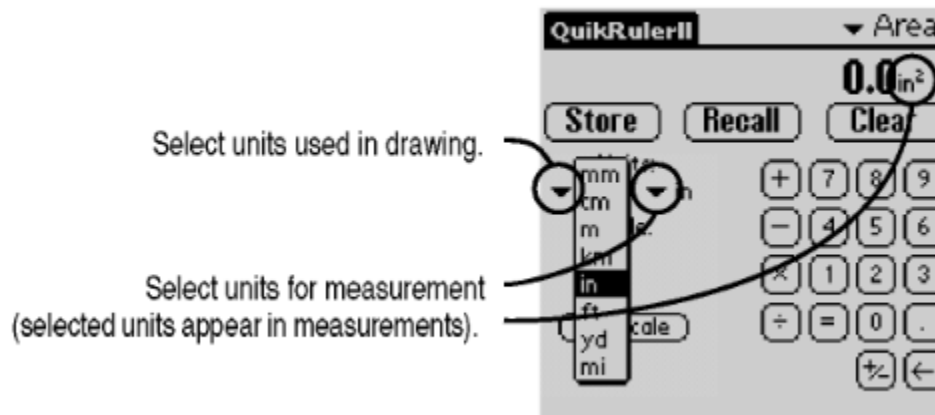

Scale

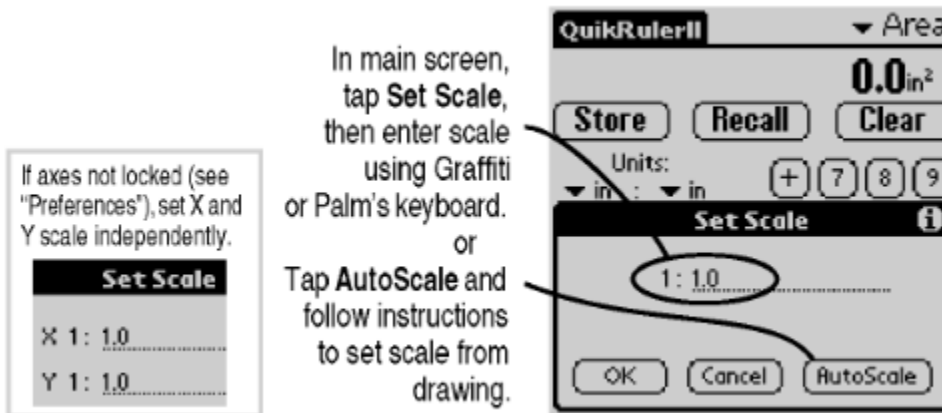

Making Measurements

Measure using the digitizer's stylus or cursor.

To measure **Length Segment** select segment endpoints.



To measure **Length Continuous** trace curve.



To measure **Perimeter** or **Area**: select segment endpoints and/or trace curves.

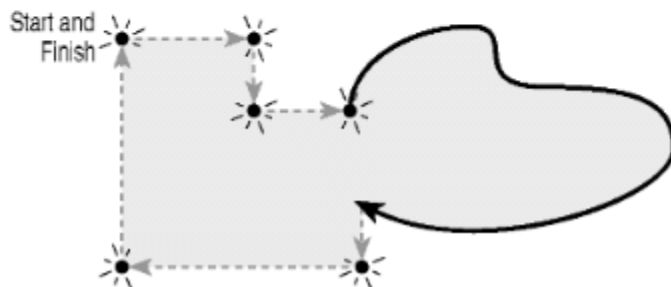

NOTE: Unless you start a new measurement, multiple measurements are cumulative. To start a new measurement, **Clear** (or **Store** and **Clear**) the last measurement.

Calculations

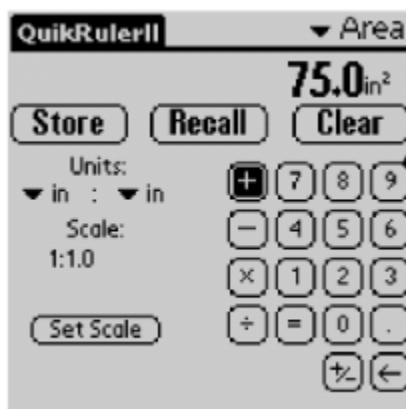



After making a measurement, use keypad to apply calculations, then tap = to view results.

Example: A room is to have 2' by 4' ceiling tiles installed. After measuring the room's area as 320 square feet, tap \div $2 \div 4 =$ to determine that 40 tiles will be required.

Combining Measurements

Multiple measurements can be combined to provide a single result. For example, to determine the gray area at right:

1. Measure area using outer perimeter A.
2. Tap  on keypad.
3. Measure inner area using perimeter B.
4. Tap  on keypad.
5. Measure inner area using perimeter C.
6. Tap  to view the result.

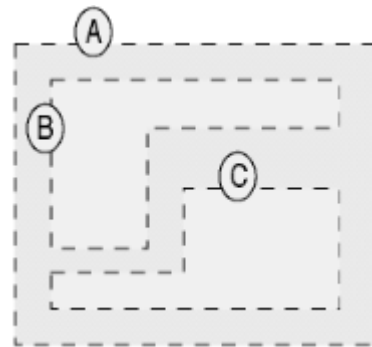

Or: Area A – Area B – Area C = Gray area

Categories

A **category** holds multiple measurements collected for a job or project. **Store** or **Recall** data as needed.

Select category to store data.
OR
Edit Categories to create, rename or delete categories.

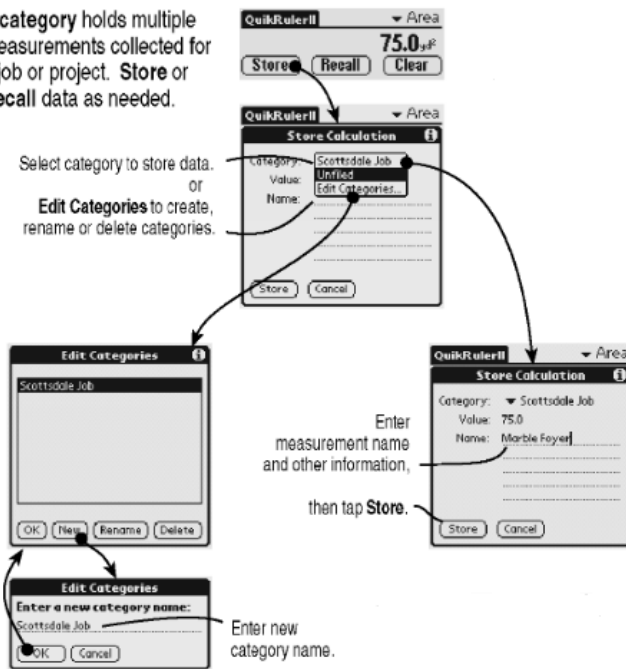



NOTE: Use **Copy** and **Paste** functions to move data between QuikRuler II and other Palm applications.

NOTE: After HotSync, TAB-delimited data is stored in *QuikRuler.txt* file in QuikRuler folder under user account name.

Using QuikRuler II

In a typical QuikRuler II session, you might:

- **Set preferences:** set decimal places, lock/unlock axis scales and flip axes.
 - See "Preferences"
- **Select a function:** count, length segment, length continuous, perimeter and area.
 - See "Measureable Functions"
- **Set units** for drawing and measurement results.
 - See "Units"
- **Set scale factor.**
 - See "Scale"
- **Make a measurement.**
 - See "Making Measurements"
- **Perform calculations.**
 - See "Calculations"
- **Combine multiple measurements.**
 - See "Combining Measurements"
- **Store data:** create/rename categories, store data and recall data.
 - See "Categories"

NOTE: For more information about QuikRuler II, see the help file on the QuikRuler II CD-ROM.